

## Flush and extended pushbuttons

### Illuminated

### Momentary and maintained

Bulb max 1.2 W

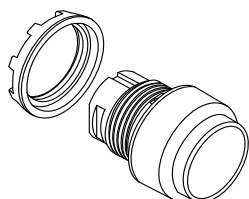
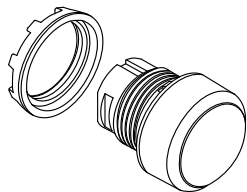

Bezel in black plastic as standard

Bezel in metal:

Replace '1' in the:

Catalog No. MPX-1 0X

Ref. Code 1SFA611XXX R 1XXX

3 for metal bezel

4 for grey plastic bezel

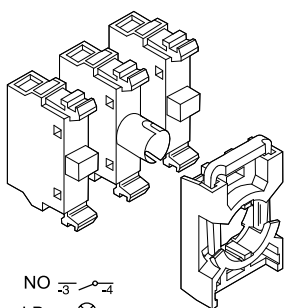

NO  $\frac{3}{-}$   $\frac{4}{-}$   
 LB  $\frac{x1}{\otimes}$   $\frac{x2}{\otimes}$   
 NC  $\frac{1}{-}$   $\frac{2}{-}$

#### Operator ...

Description	Catalog No.	Ref. Code	List Price
<b>with flush button</b>			
<b>Momentary ①</b>			
Red	<b>MP1-11R</b>	1SFA 611 100 R1101	<b>\$ 6.10</b>
Green	<b>MP1-11G</b>	1SFA 611 100 R1102	
Yellow	<b>MP1-11Y</b>	1SFA 611 100 R1103	
Blue	<b>MP1-11L</b>	1SFA 611 100 R1104	
White	<b>MP1-11W</b>	1SFA 611 100 R1105	
Clear	<b>MP1-11C</b>	1SFA 611 100 R1108	
<b>Maintained ①③</b>			
Red	<b>MP2-11R</b>	1SFA 611 101 R1101	<b>17.30</b>
Green	<b>MP2-11G</b>	1SFA 611 101 R1102	
Yellow	<b>MP2-11Y</b>	1SFA 611 101 R1103	
Blue	<b>MP2-11L</b>	1SFA 611 101 R1104	
White	<b>MP2-11W</b>	1SFA 611 101 R1105	
Clear	<b>MP2-11C</b>	1SFA 611 101 R1108	
<b>with extended button</b>			
<b>Momentary ①</b>			
Red	<b>MP3-11R</b>	1SFA 611 102 R1101	<b>6.10</b>
Green	<b>MP3-11G</b>	1SFA 611 102 R1102	
Yellow	<b>MP3-11Y</b>	1SFA 611 102 R1103	
Blue	<b>MP3-11L</b>	1SFA 611 102 R1104	
White	<b>MP3-11W</b>	1SFA 611 102 R1105	
Clear	<b>MP3-11C</b>	1SFA 611 102 R1108	
<b>Maintained ①③</b>			
Red	<b>MP4-11R</b>	1SFA 611 103 R1101	<b>17.30</b>
Green	<b>MP4-11G</b>	1SFA 611 103 R1102	
Yellow	<b>MP4-11Y</b>	1SFA 611 103 R1103	
Blue	<b>MP4-11L</b>	1SFA 611 103 R1104	
White	<b>MP4-11W</b>	1SFA 611 103 R1105	
Clear	<b>MP4-11C</b>	1SFA 611 103 R1108	

#### Contact blocks, lamp block and holder ②

Blocks	Catalog No.	Ref. Code	List Price
1 NO + 1 LB with holder	<b>MCBH-101</b>	1SFA 611 605 R1201	<b>\$ 27.50</b>
1 NC + 1 LB with holder	<b>MCBH-011</b>	1SFA 611 605 R1210	<b>27.50</b>
2 NO + 1 LB with holder	<b>MCBH-201</b>	1SFA 611 605 R1202	<b>35.50</b>
2 NC + 1 LB with holder	<b>MCBH-021</b>	1SFA 611 605 R1220	<b>35.50</b>
1 NO + 1 NC + 1 LB with holder	<b>MCBH-111</b>	1SFA 611 605 R1211	<b>35.50</b>
1 NO without holder	<b>MCB-10</b>	1SFA 611 610 R1001	<b>8.00</b>
1 NC without holder	<b>MCB-01</b>	1SFA 611 610 R1010	<b>8.00</b>
Lamp block for 2 W, max 230 V AC/DC bulb or LED	<b>MLB-1</b>	1SFA 611 620 R1001	<b>17.50</b>
Holder for 3 blocks	<b>MCBH-00</b>	1SFA 611 605 R1100	<b>2.00</b>

#### Ordering example

Requested: A modular pushbutton, maintained and illuminated with green flush button and one NO + one NC contact.

Ref.: 1 piece of MP2-11G + 1 piece of MCBH-111  
 Bulb - see accessories

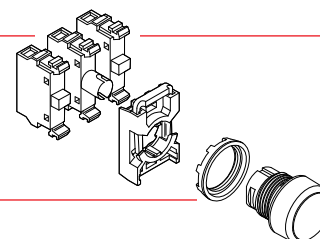

- ① No contact block in the center position
- ② Lamp block MLB-1. Bulb not included. For other lamp blocks see Accessories.
- ③ Bulb max 1.2 W, not included.